

南陣山町

10

南陣山町

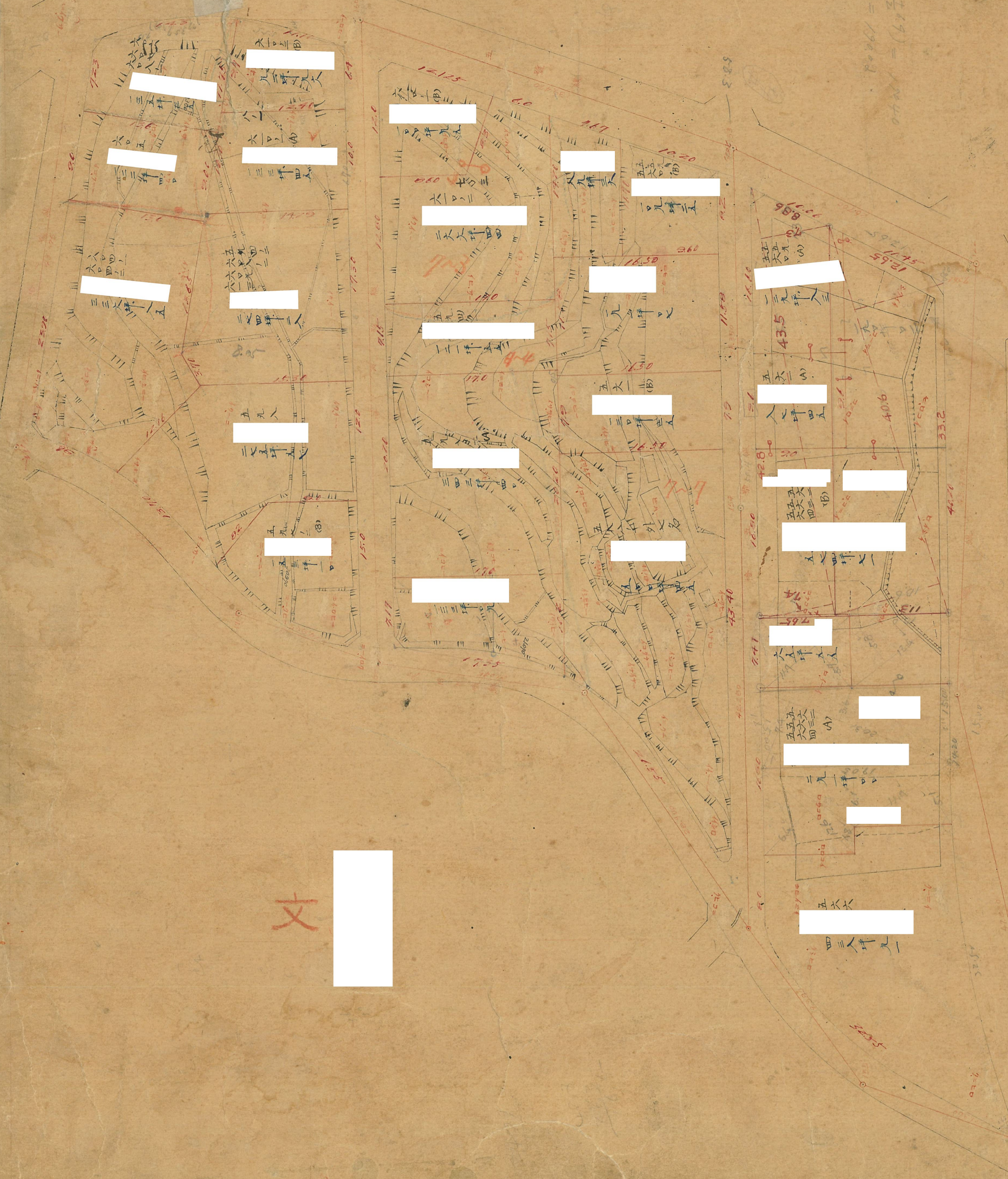

$43.5 \times (14.4 + 1.3) \div 2 = 318.71$
 $40.6 \times (10.6 + 9.5) \div 2 = 407.30$

$125 \times (6.4 + 1.3) = 102.50$
 $19.0 \times 5.0 = 95.00$
 $14.7 \times 5.0 = 73.50$
 275.10
 130.50

190.02
318.77
219.47
137.50

865.76 = 865.71

604 22847

21847

646.06

676.69

$8000 \div 100 = 80$
 $8000 \div 100 = 80$